





Quick Start Guide | Guía de Inicio Rápido |  
Guida Rapida | Guia de Inicio Rápido

# DULCOFLEX DFXa



|   |   |    |
|---|---|----|
|  | Peristaltic Metering Pump DULCOFLEX DFXa.....       | 2  |
|  | Bomba Dosificadora Peristáltica DULCOFLEX DFXa..... | 19 |
|  | Pompa Peristaltica di Dosaggio DULCOFLEX DFXa.....  | 36 |
|  | Bomba de Dosagem Peristáltica DULCOFLEX DFXa.....   | 53 |



PeristalticPump.ir



# Content

## Content

|                               |    |
|-------------------------------|----|
| Service and Spare Parts ..... | 3  |
| Scope of Delivery.....        | 4  |
| Safety .....                  | 5  |
| Overview .....                | 6  |
| Technical Data .....          | 7  |
| Mounting .....                | 8  |
| Install Electrically.....     | 9  |
| Start-up.....                 | 11 |
| Install Hydraulically.....    | 12 |
| Start-up.....                 | 17 |

This document does not replace the original operating instructions. To operate the pump safely and completely, read the operating instructions carefully. You can find the original operating instructions in the available languages on the product page under Downloads:



<http://www.prominent.com/en/dfxa>

## Personnel Requirements

The mounting and installation of the pump should only be carried out by qualified, trained personnel.



**Info:** Die deutsche Version des Quick Start Guides finden Sie auf Seite 19. | For the German version please go to page 19.

PeristalticPump.ir



## Service and Spare Parts



To order service and spare parts, please visit our Service Page on [www.prominent.com](http://www.prominent.com) or contact your local sales representative.

PeristalticPump.ir



## Scope of Delivery

Check the scope of delivery:

- Dosing pump with power cable
- Product-specific operating instructions
- Connection kit
- Accessories according to the identity code
- Pump tube
- Rotor half
- Grease

Optional accessories for your pump can be found in the ProMinent WebShop\* or ordered from your local sales person.

Screws for the mounting holes are not included in the scope of delivery.  
Use screws with diameter < 4.5 mm.

\* The WebShop is only available in selected countries. Please check your local ProMinent website to see if there is one available in your country.

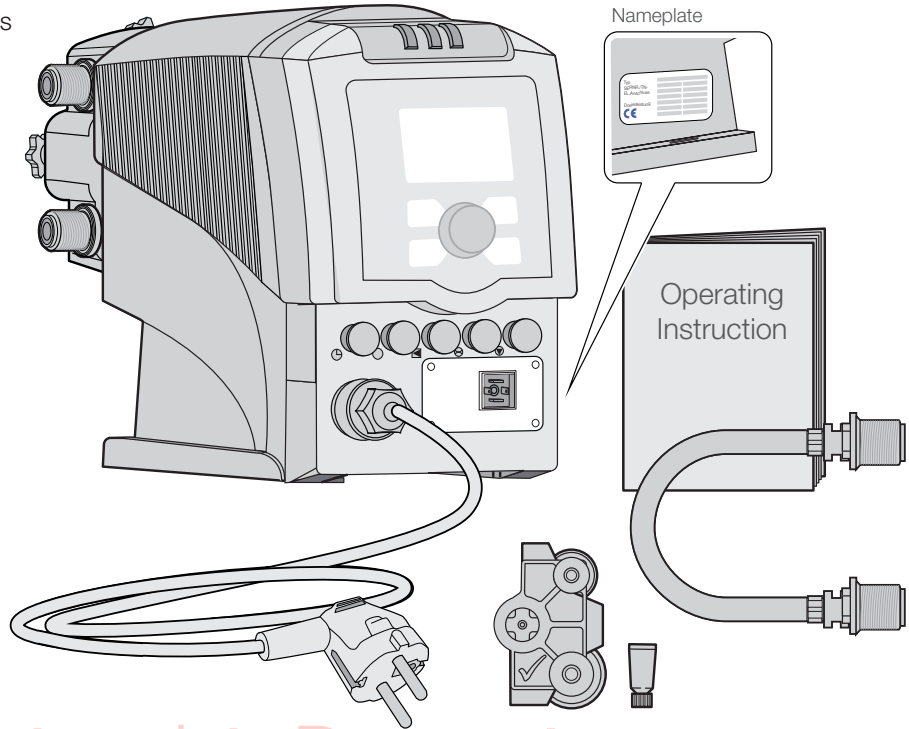

PeristalticPump.ir



## Safety

Read the "Safety" chapter in the operating instructions for the pump and the safety and warning notes in the safety data sheet for the dosing medium used.

### **WARNING!**

#### **Danger to life from electric shock**

- Regularly check the power supply cable for damage and wear.
- If there is visible damage to the pump or power supply cable, do not switch on the pump and secure it against being switched on again.
- Disconnect the device from the power supply before working on the pump.
- Let damaged cables replace by qualified personnel.
- Only use original spare cables.

### **CAUTION!**

#### **Uncontrolled start of the dosing process**

The pump can start the dosing process in an uncontrolled manner when connected to the mains voltage.

- Equip the pump with an emergency stop switch in the power line.
- Pay attention to error messages during commissioning.
- Depressurize the hydraulic parts before carrying out any work on the pump.

### **NOTICE**

#### **Material damage due to burst hydraulic parts**

If the maximum permissible operating pressure is exceeded, hydraulic parts may burst.

- Open the hydraulic side before operating the pump.
- Install an overflow valve in the discharge line.
- During operation, pay attention to the operating pressure indications on the display.

### **NOTICE**

#### **Material damage due to the use of a medium that is unsuitable for the tube**

The use of a dosing medium that is unsuitable for the pump tube can damage the wetted parts of the pump.

- Check whether the tube you are using is suitable for your medium. Observe the chemical resistance list.
- After finishing operation, check all hose and pressure lines and their connections for damage.
- Let any damage that may have occurred repair by the maintenance personnel.



ProMinent Chemical Resistance List

Peristaltic Pump.ir



# Overview

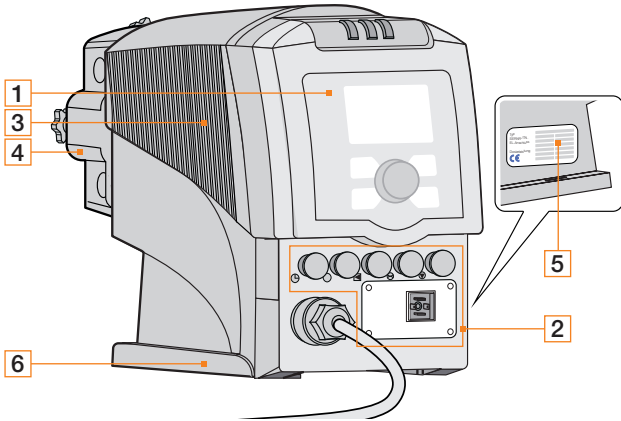

- 1 Control unit (with cover flap)
- 2 Sockets and relays
- 3 Drive unit
- 4 Liquid end
- 5 Nameplate
- 6 Mounting holes
- 7 Connection thread tube
- 8 Star-shapes screw
- 9 Bearing cover
- 10 Thread for tube rupture sensor

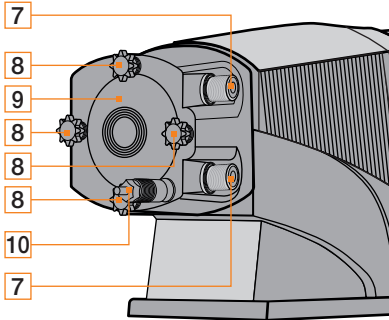

**Note:** The appearance may differ depending on the liquid end.

### LED Indicators

|  |                          |  |
|--|--------------------------|--|
|  | Fault indicator [10]     | Fault message  |
|  | Warning indicator [11]   | Warning message  |
|  | Operating indicator [12] | Pump is ready for operation. LED flashes with each revolution. At less than 30 revolutions it flashes once a second. |

### Control unit

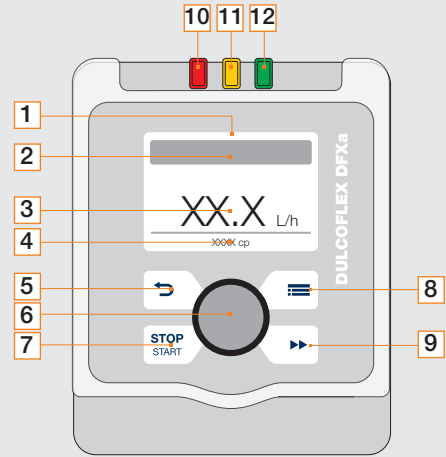

- 1 LC Display
- 2 Status bar
- 3 Main display
- 4 Secondary display
- 5 [Back] key
- 6 Clickwheel
- 7 [STOP/START] key
- 8 [Menu] key
- 9 [Priming] key

# Technical Data



0 ... 45 °C

5 ... 45 °C (TPV, PUR, SEBS)

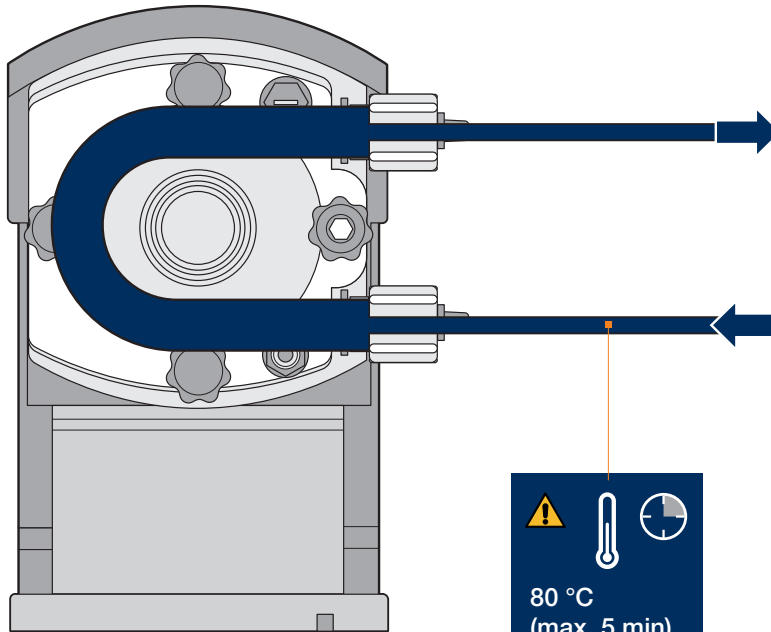

80 °C  
(max. 5 min)



max. 95% (rel.)



max. 2,000 m (NN)



< 70 dB (LpA)



IP 66

## NOTICE

When selecting the dosing medium, observe the resistance of the materials in contact with the medium.



ProMinent Chemical Resistance List



# Mounting

## Observe the following mounting instructions:

Access to the dosing head is necessary for changing the tube. Therefore, ensure sufficient space around the pump, at least  $\geq 80$  mm.

### NOTICE

To be able to change the tube, mount the pump free-standing.

## Mount Pump

To attach the pump to the ground, screw the pump to the mounting holes provided on both sides using a screw with a diameter  $< 4.5$  mm.

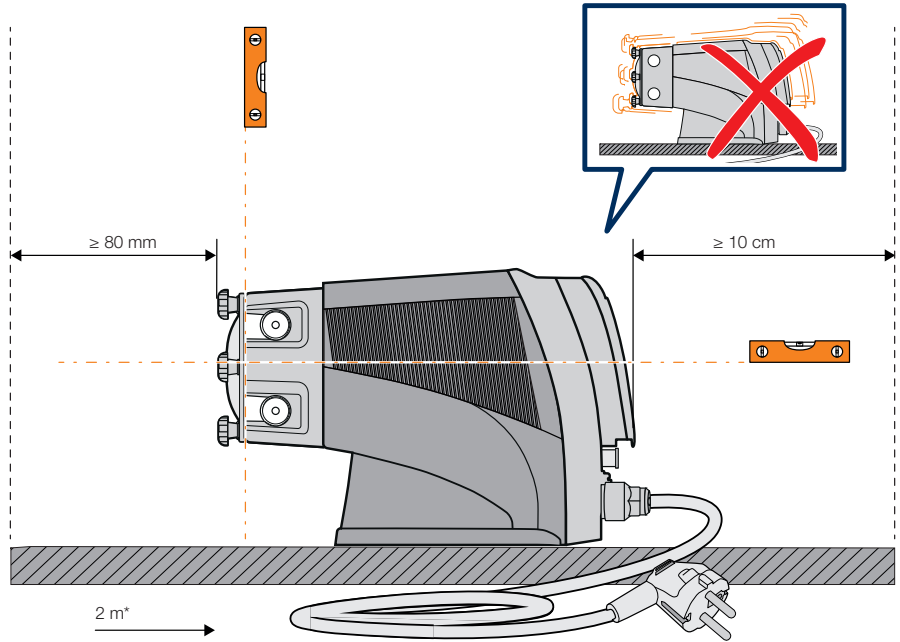
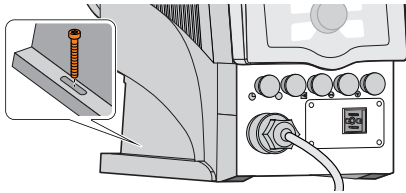

100 – 230 V  $\pm 10$  %  
50/60 Hz



PeristalticPump.ir

\* available in other versions and lengths





# Install Electrically

- 1 Config I/O socket ☒
- 2 Tube rupture indicator ○
- 3 External control ☒
- 4 Metering monitor (no function) ☒
- 5 Level switch ☒
- 6 Slot for accessory (e. g. fault indicating relay)

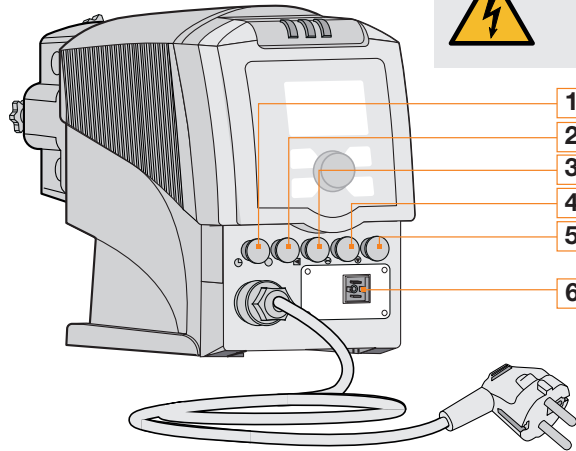

100 – 230 V ±10 %  
50/60 Hz



For detailed information on further accessories on sockets or the relay, please refer to the operating instructions.

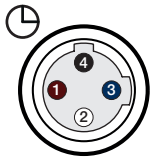

### "Config I/O" socket

|          |       |              |
|----------|-------|--------------|
| <b>1</b> | brown | Config I/O 1 |
| <b>2</b> | white | Config I/O 2 |
| <b>3</b> | blue  | Config I/O 3 |
| <b>4</b> | black | GND          |

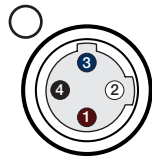

### Tube rupture indicator

|          |       |               |
|----------|-------|---------------|
| <b>1</b> | brown | Voltage (5 V) |
| <b>2</b> | white | not assigned  |
| <b>3</b> | blue  | Sensor signal |
| <b>4</b> | black | GND           |

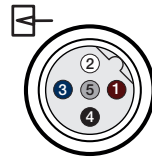

### External control

|          |       |                  |
|----------|-------|------------------|
| <b>1</b> | brown | Pause            |
| <b>2</b> | white | External contact |
| <b>3</b> | blue  | mA input         |
| <b>4</b> | black | GND              |
| <b>5</b> | grey  | Auxiliary        |

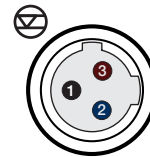

### Level switch

|          |       |             |
|----------|-------|-------------|
| <b>1</b> | black | GND         |
| <b>2</b> | blue  | Pre-warning |
| <b>3</b> | brown | Limit stop  |



# Install Electrically

## Retrofit of Relay

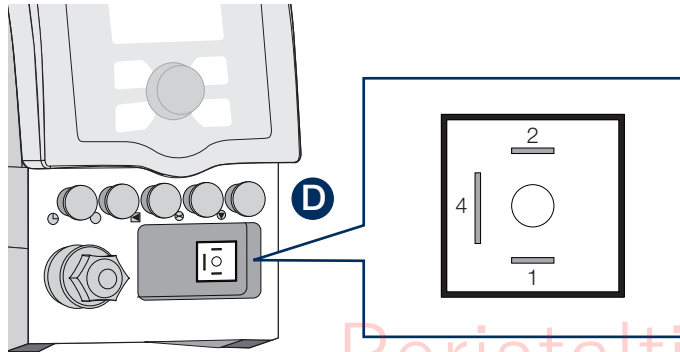
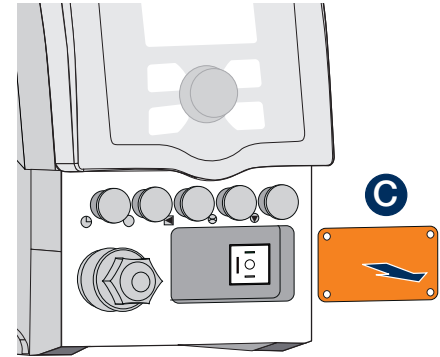
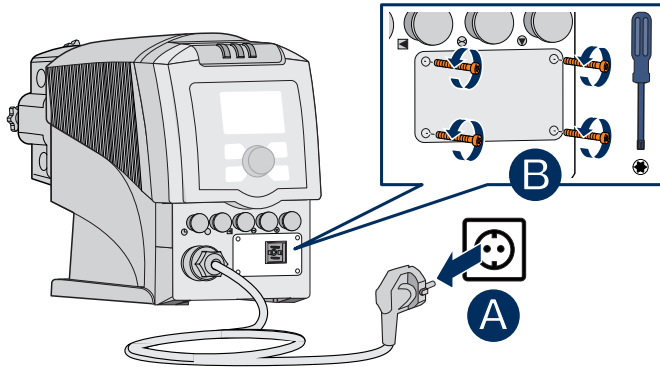

### Example: Fault indicating relay (EU version)

|   |       |    |
|---|-------|----|
| 1 | white | NO |
| 2 | green | NC |
| 4 | brown | C  |



For detailed information on other relays, please refer to the operating instructions.





# Start-up

## Set language

1



2



3

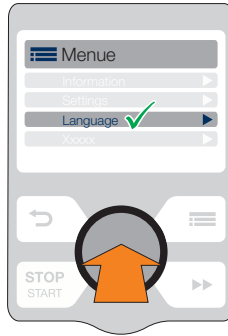

4

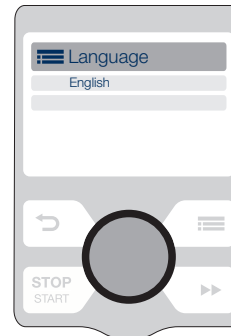

5



PeristalticPump.ir



# Install Hydraulically

1 Grease the tube.

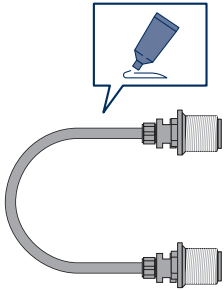

2

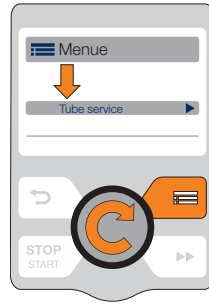

3

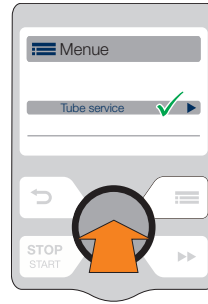

4



Wait until the next instruction.



5



**Attention! Contrary to the instruction displayed in the operating menu, do not remove the rotor during initial installation!**

The second rotor half is supplied separately.

The rotor half that must never be removed is marked with X.

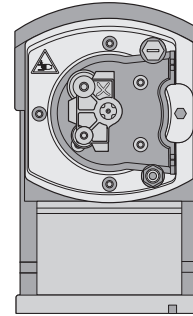
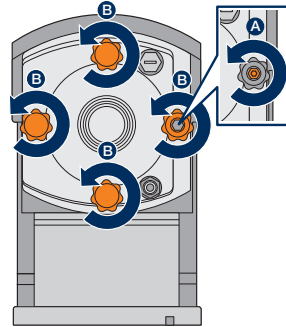

6

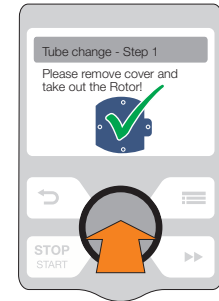

PeristalticPump.ir



# Install Hydraulically

7

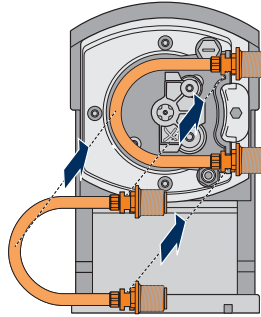
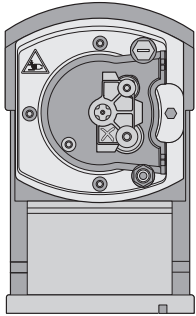

8

Wait until the next instruction.

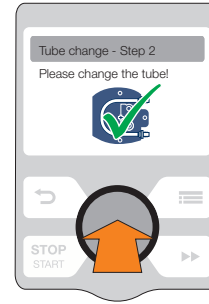

9

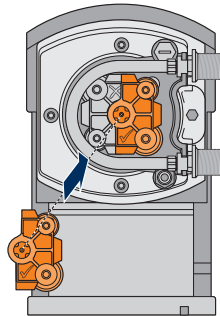

10

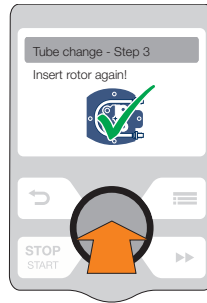

Wait until the next instruction.



PeristalticPump.ir



# Install Hydraulically

11

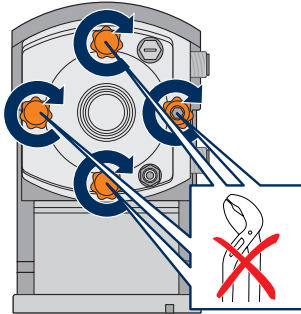
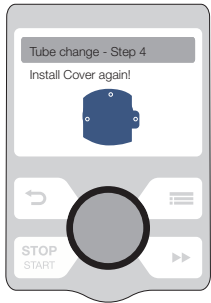

12

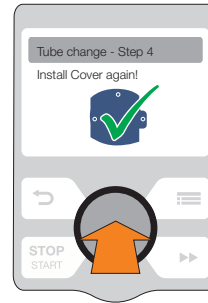

13



14 Adjust the maintenance interval.

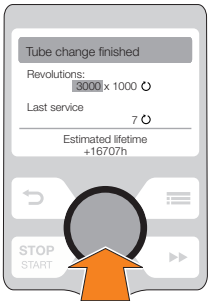

15

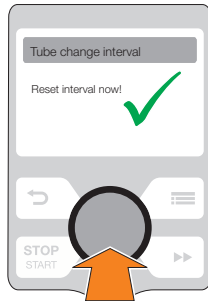

16

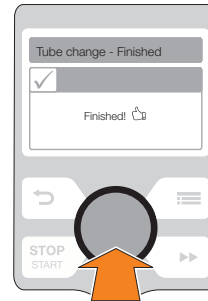

PeristalticPump.ir



# Install Hydraulically



## CAUTION!

### Danger from dosing medium splashing around

Improper installation may cause dosing medium to leak.

- Always wear safety equipment like glasses, gloves and chemical overall when working on the hydraulic.

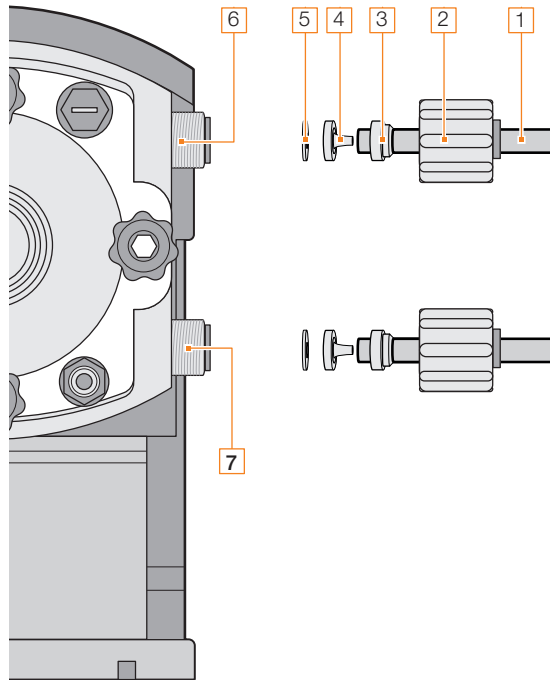

## Version plastic

- 1 Hose\*
- 2 Union nut
- 3 Clamping ring
- 4 Tube nozzle
- 5 O-ring or flat seal
- 6 Tube connection
- 7 Tube connection

\* On the pressure side use a pressure-resistant hose.



For detailed information on valve variations, please refer to the operating instructions.



# Peristaltic Pump



# Install Hydraulically

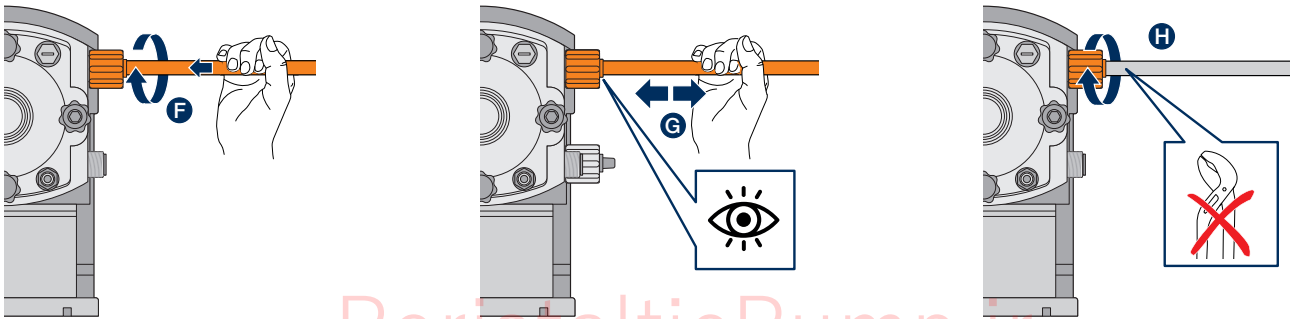
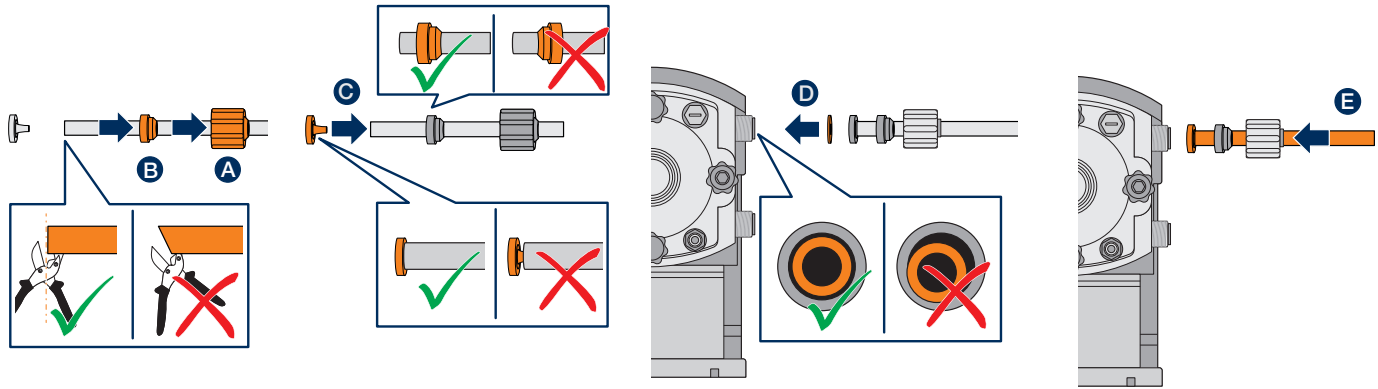

PeristalticPump.ir





# Start-up

## Calibrate Pump

- Run the pump 200 revolutions before calibration.
- Perform the calibration from the suction side.

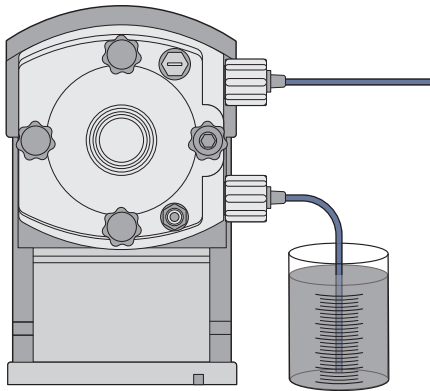

1

2

3

4

5

6

7

8

PeristalticPump.ir



# Start-up

9 Wait until at least 100 revolutions have been made.

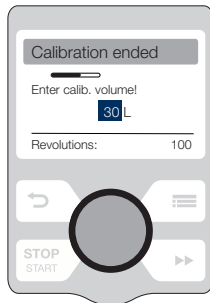
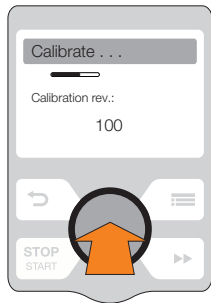

10

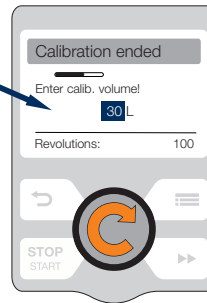
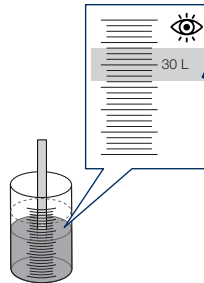

11

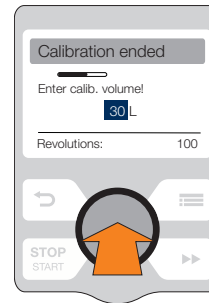

12

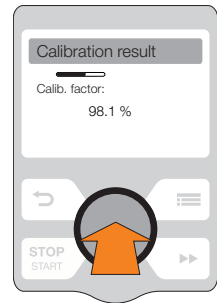

13



## Make Settings

You can access the other settings for your pump via the main menu, e. g.

- Operating mode
- Dosing direction
- Priming time



For detailed information on the settings of your pump, please refer to the operating instructions.



PeristalticPump.ir